

SUBJECT: Upper Unit Problem

DATE: July 15, '92

PAGE: 1 of 4

PREPARED BY: S. Orita

FROM: Copier Technical Support Section

CHECKED BY:

CLASSIFICATION:

☒ Action Required

☐ Troubleshooting

☐ Retrofit Information

☐ Revision of service manual

☐ Information only

☐ Other

MODEL:

E7 Series (A077/A078)

E7 DF (A365)

Symptom: The upper unit cannot be held at an angle of 16 degrees with the DF when the upper unit is opened. This is due to variation in the tolerance of the torsion springs.

Solution: To hold the upper unit and DF at a proper position, the upper unit stand kit (consists of 6 parts, see below) will be packed as an accessory to the E7 DF (A365) from the July production. The cut-in serial numbers will be informed by the MB.

Contents of the Kit

Upper Unit Stand (P/N A3651485)	1pc
Magnet (P/N A3651486)	1pc
Instruction Decal (P/N A3652080)	1pc
Stepped Screw (long) (P/N 54465832)	1pc
Stepped Screw (short) (P/N AA143183)	1pc
Screw driver (P/N A3656001)	1pc

When the DF is installed to the copier in the field, this kit should also be installed to the copier.

NOTE: For the DF units that we have already produced without the kits, we will send a countermeasure kit. The contents of the countermeasure kit are exactly same as described above.

How to Use the Upper Unit Stand

After the upper unit stand is installed to the copier, instruct the customer how to use the upper unit stand as follows:, when there is a paper misfeed in the copier.

1. Open the front cover.

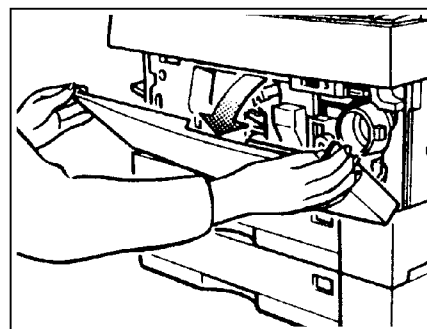

SUBJECT: Upper Unit Problem

DATE: July 15, '92

PAGE: 2 of 4

2. Press the release lever, lift the upper unit.

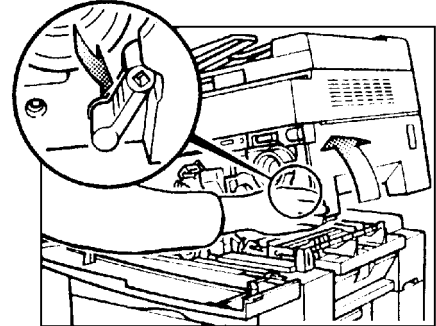

3. Make sure to use the upper unit stand to keep the upper unit open as shown in the illustration.

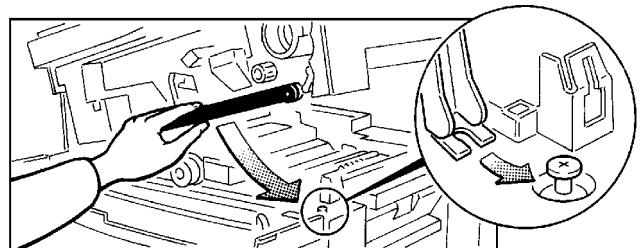

4. After a paper misfeed removal, replace the upper unit stand in its original position.

New DF Installation Procedure

The new DF installation procedure is as follows:

CAUTION: When installing the DF, make sure that the copier is unplugged.

1. Remove the platen cover [A] from the copier.
2. Remove the strips of tape from the DF.

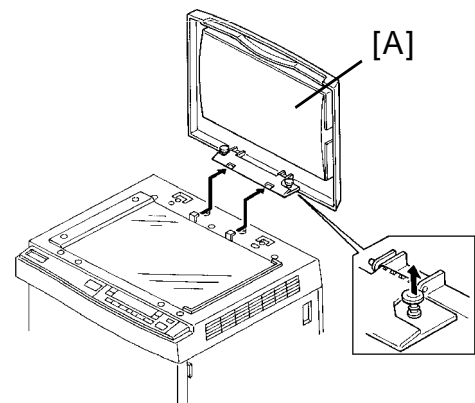

SUBJECT: Upper Unit Problem

DATE: July 15, '92

PAGE: 3 of 4

3. Insert the DF [B] into the holes [C] of the copier upper cover.
4. Secure the DF to the copier (2 thumb screws [D]).

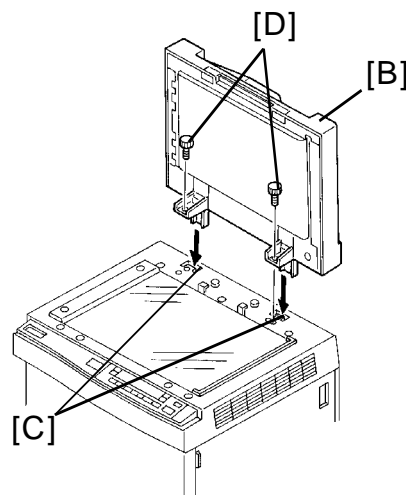

5. Remove the seal [E] from the outlet of the copier.
6. Plug in the optics fiber cable [F] to the DF and the copier as shown.
7. Plug in the power supply cord [G] of the DF to the outlet of the copier rear cover as shown.

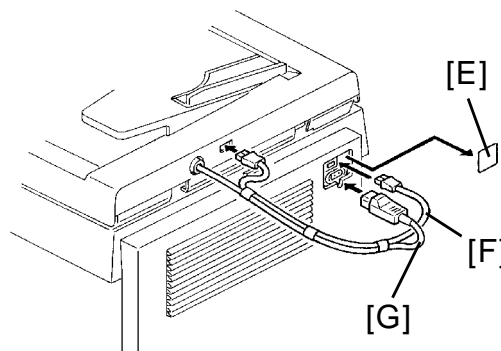

8. Install the original table [H] as shown.

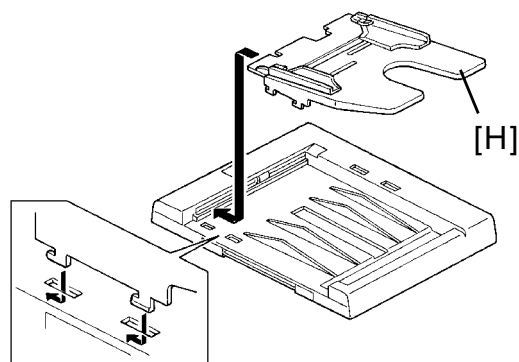

SUBJECT: Upper Unit Problem

DATE: July 15, '92

PAGE: 4 of 4

9. Open the front cover.
10. Lift the upper unit.
11. Remove 2 screws [I].
12. Tighten the shorter stepped screw [J].
13. Install the upper unit stand [K]
(1 longer stepped screw [L]).

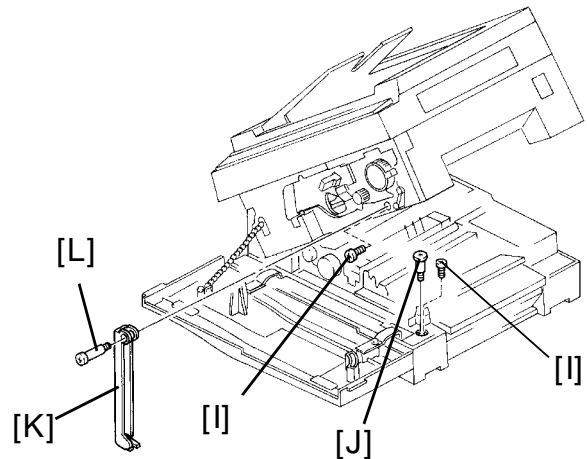

14. Stick the magnet [M] as shown.

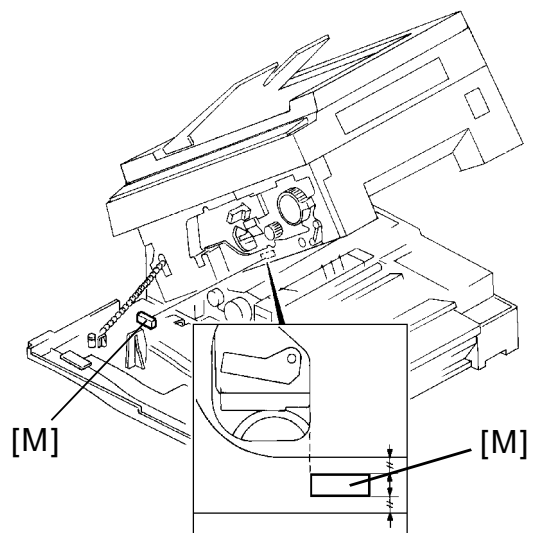

15. Stick the decal [N] as shown.
16. Close the upper unit and the front cover.
17. Check the operation of the DF.
18. Instruct key operators how to use the upper unit stand.

